

# DOCTOR PAYNE™

## INSTALLATION AND OPERATING INSTRUCTIONS

KEEP ALL PLASTIC AND WIRE PARTS AWAY FROM CHILDREN

WARNING: DO NOT TURN ON THE PROP UNTIL FULLY ASSEMBLED. STAY CLEAR OF THE PROP WHILE OPERATING. ESTIMATED ASSEMBLY TIME TEN MINUTES.

1. METAL BASE
2. SHOES
3. LOWER LEG POLES
4. UPPER LEG POLES WITH CONTROL BOX
5. PANTS
6. WAIST FRAME AND MODULE
7. HAND
8. ARM POLE WITH FOAM
9. ARM WITH TORCH
10. HEAD, BODY, & FOG HOSE
11. 6V 2A ADAPTER
12. FOG CORD & ADAPTER
13. FOG CLAMP
14. SNAP LOCK REMOVAL TOOL

### PARTS



### ASSEMBLY



1. Insert and snap lock the LOWER LEG POLES to the METAL BASE.

MATCH A TO A  
MATCH B TO B

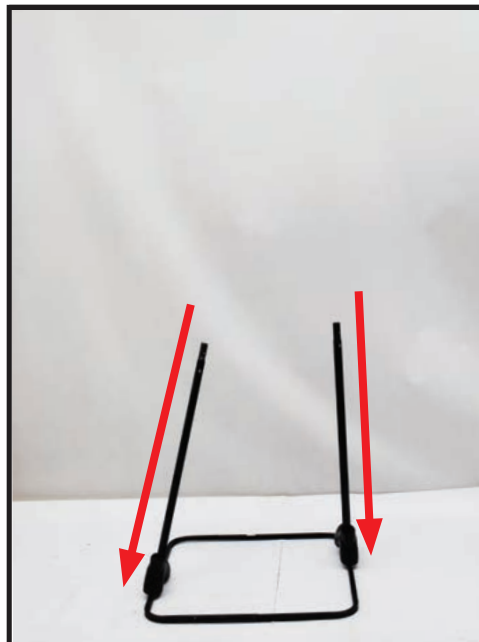

2. Slide SHOES over the LOWER LEG POLES and down to the METAL BASE. Have the front of the SHOES face the FRONT label of the METAL BASE.

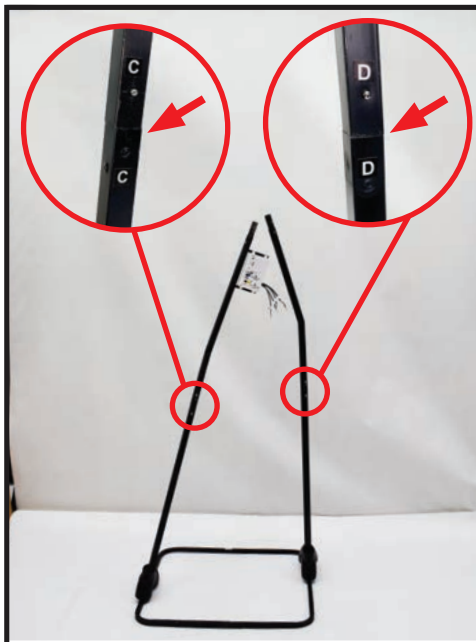

3. Insert and snap lock the UPPER LEG POLES WITH CONTROL BOX to the LOWER LEG POLES.

MATCH C TO C, MATCH D TO D



4. Slide PANTS over the LEG POLES.



5. Insert and snap lock the WAIST FRAME & MODULE to the LEG POLES.

MATCH E TO E  
MATCH F to F

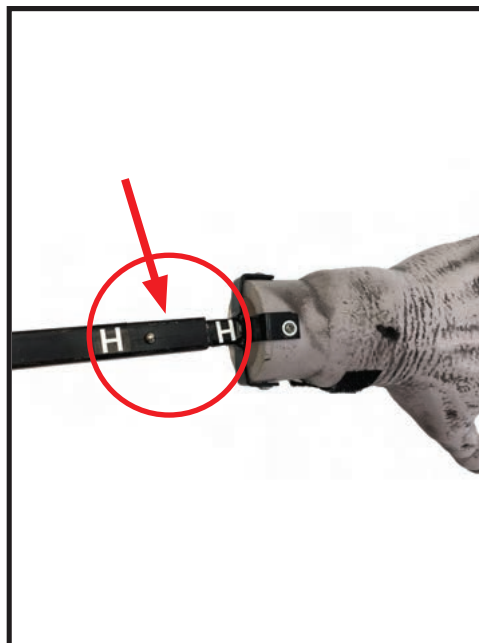

6. Insert and snap lock the ARM POLE WITH FOAM to the HAND.

MATCH H TO H

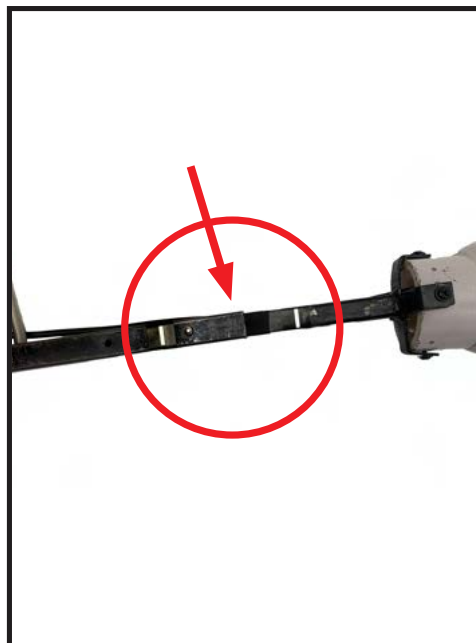

7. Insert and snap lock the ARM WITH TORCH's wrist together.

MATCH I TO I



7. Insert and snap the ARM POLE to the HEAD & BODY's shoulder frame. Hook and loop fasten the sleeve to the wrist.

MATCH J TO J

## ASSEMBLY



9. Insert and snap the ARM WITH TORCH to the HEAD & BODY's shoulder frame. Hook and loop fasten the sleeve to the wrist.  
MATCH K TO K



10. Insert and snaplock the HEAD & BODY to the WAIST FRAME & MODULE.  
MATCH G TO G

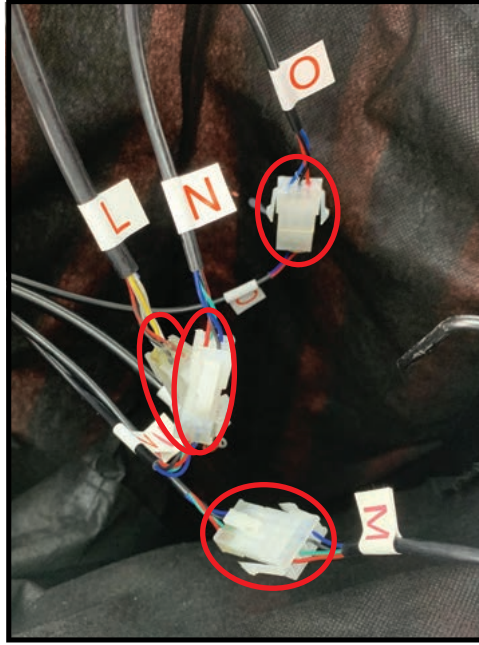

11. Connect wires to the CONTROL BOX.  
MATCH L TO L (Body Movement)  
MATCH M TO M (LEDs in eyes)  
MATCH N TO N (LEDs in Torch)  
MATCH O TO O (Human Sensor)

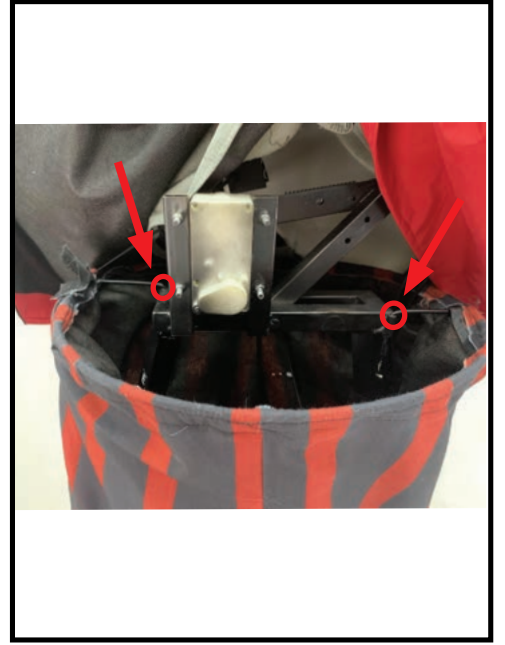

12. Insert the PANTS wire frame posts into the holes located on the WAIST FRAME.



13. Hook and loop fasten the shirt to the the PANTS. Adjust the fabric of the HEAD & BODY over the PANTS wire frame.

## OPERATING INSTRUCTIONS

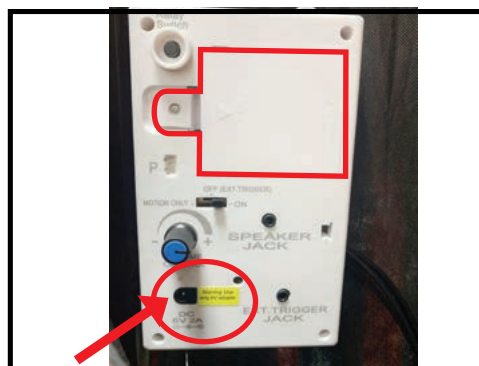

Plug in the 6V 2A ADAPTER (included) or insert 4 AA BATTERIES (not included) into the battery compartment located on the CONTROL BOX.



Position the item with the human sensor pointing forward. Move in front of the item or make a loud sound (clap) for activation **AFTER** your fog machine set up.

Leave the switch in the OFF position when not in use.

**PROCEED TO FOG MACHINE SET UP.**

## ! FOG MACHINE INFORMATION

Please follow steps 1 through 12 on the assembly instructions before beginning assembly:

1. Your fog machine (400 or 1000 watt) can be used in conjunction with DOCTOR PAYNE™.
2. Do not use with any other fog machine.
3. FOG MACHINE IS NOT INCLUDED. MUST BE PURCHASED SEPARATELY.
4. Manufacturer does not guarantee the performance of the fog machine.
5. Make sure to use the supplied fog machine components when hooking up to the fog machine, or damage could occur.
6. MAKE SURE DOCTOR PAYNE™ IS SET TO THE "OFF" POSITION AND YOUR FOG MACHINE IS TURNED OFF WHEN NOT IN USE.

Fog Clamp - PATENT <https://tekkydesign.com/pages/terms-conditions.php>



**FOG MACHINE ASSEMBLY INSTRUCTIONS:**

1. Fog hose will click and secure in place.  
(See Illustration A)

Depress the lever arms of the FOG CLAMP and attach to the fog machine nozzle.  
(See Illustration B)

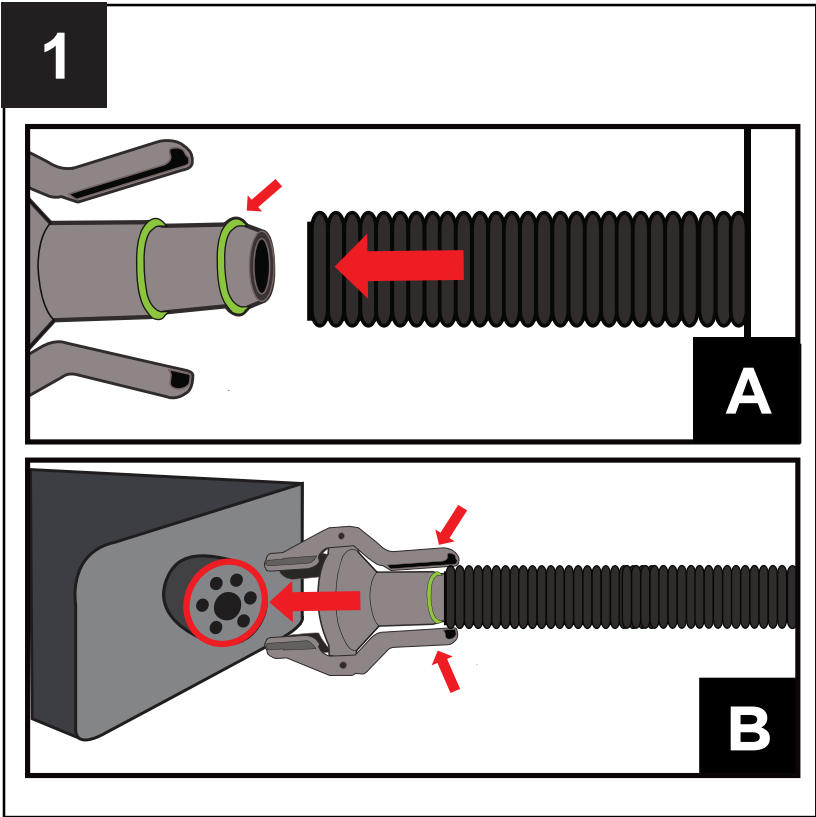
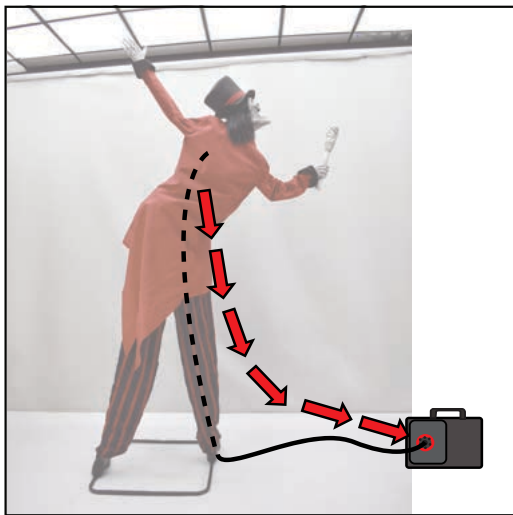

2. Plug the FOG CORD into your fog machine. If the FOG CORD does not fit, see illustration 2a.

2a. Plug the FOG CORD into the FOG ADAPTER. Plug FOG ADAPTER into your fog machine.

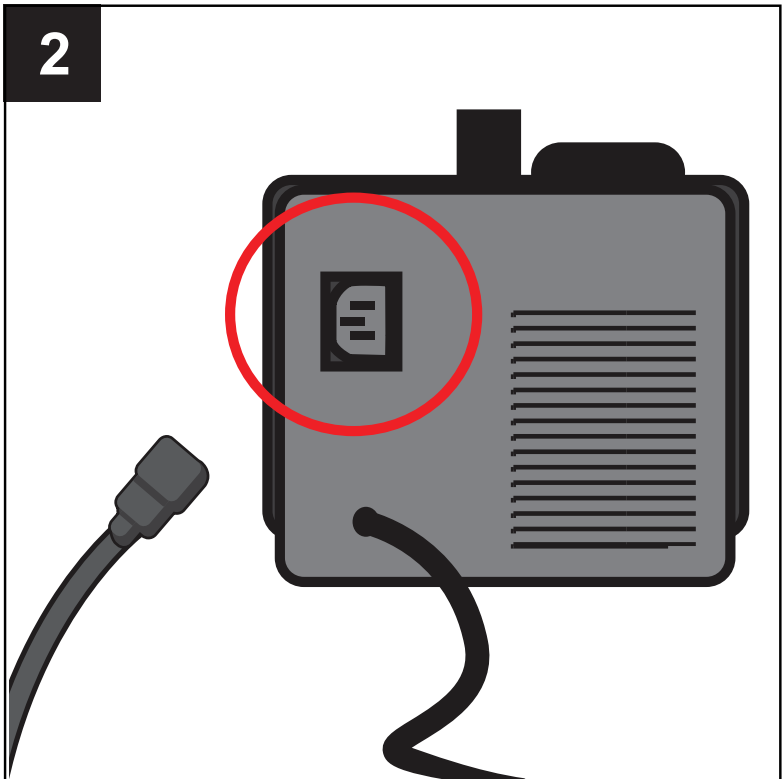
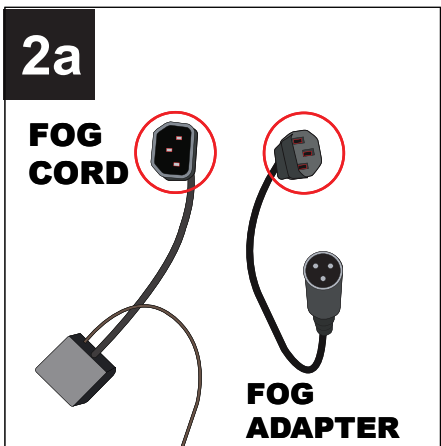

3. Plug the other end of the FOG CORD & ADAPTER into the jack labeled P on the CONTROL BOX.

MATCH P to P

Make sure the fog machine is heated up properly, turn your fog machine ON, and then turn DOCTOR PAYNE’S switch to the “ON” position. Make a loud sound (clap) or move in front of the item.

If no fog appears, press the relay switch.

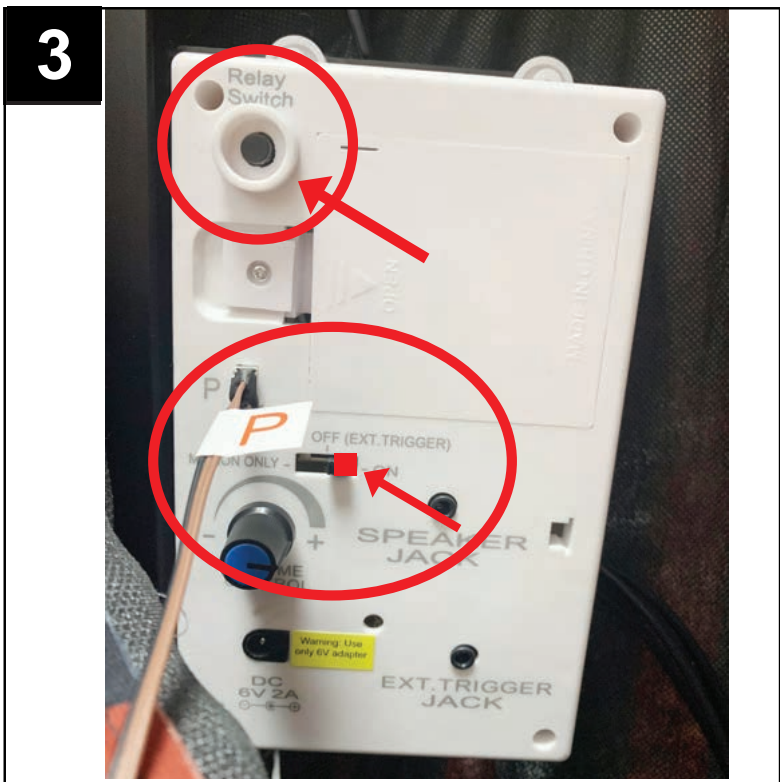

### OPTIONAL EXTERNAL TRIGGER SET UP

EXT. TRIGGER IS NOT INCLUDED. MUST BE PURCHASED SEPARATELY.

1. Insert the cable from optional EXT. TRIGGER into the jack labeled EXT. TRIGGER JACK on the CONTROL BOX.
  2. Place the switch in the OFF (EXT. TRIGGER) position to enable EXT. TRIGGER activation.
  3. Step on the EXT. TRIGGER to activate the scary sequence!
- \*EXT. TRIGGERS are sold separately and can be purchased at [www.tekkyaccessories.com](http://www.tekkyaccessories.com)



### OPTIONAL EXTERNAL SPEAKER SET UP

EXTERNAL SPEAKER IS NOT INCLUDED. MUST BE PURCHASED SEPARATELY.

1. Plug speaker cord into the jack labeled SPEAKER JACK located on the CONTROL BOX.
2. Use volume knob on external speaker to control volume levels.



### Battery Diagram

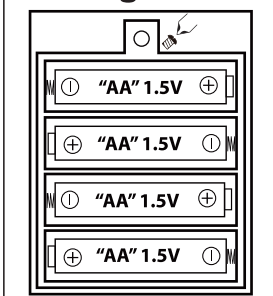

### BATTERY INSTRUCTIONS AND CAUTIONS

Battery installation and removal should be performed by an adult. Remove batteries when not in use.

Use only batteries recommended in the instructions.

Do not mix new and used batteries.

Do not mix alkaline, carbon-zinc, nickel-cadmium, rechargeable or different types of batteries.

Be mindful to insert batteries with the correct polarity (+/-) as indicated.

Remove all exhausted batteries.

Rechargeable batteries are only to be charged under adult supervision.

Rechargeable batteries are to be removed from the item before being charged.

Non-rechargeable batteries are not to be recharged.

The supply terminals are not to be short-circuited.

Always dispose of exhausted batteries properly.

Do NOT dispose of batteries in fire, they may leak or explode.

**Warning! This item is not a toy. For decoration only. Small parts, choking hazard.**  
**This product is intended for use by persons 15 years of age and older.**  
**Not intended for use by children ages 14 years and younger.**

### WARNING

**DO NOT TURN ITEM ON UNTIL YOU HAVE COMPLETELY FINISHED ASSEMBLY.**  
**STAY CLEAR OF ITEM WHILE OPERATING.**  
**DO NOT PLACE ITEM ON UNEVEN GROUND.**  
**DO NOT PLACE WEIGHT ON ITEM WHILE IN OPERATION.**



visit us at [tekkydesign.com](http://tekkydesign.com)

Requires 6V 2A ADAPTER (Included)  
or 4AA batteries (not included)

ALL NEW MATERIALS:  
METAL, FOAM, PLASTIC, POLYESTER  
Surface washable only.

DOCTOR PAYNE™  
is a trademark of Tekky.  
Copyright © 2024 Tekky.  
All Rights Reserved.  
MADE IN CHINA



**DO NOT RETURN THIS ITEM TO THE STORE!**  
If experiencing technical difficulties, please go  
to [www.tekkydesign.com](http://www.tekkydesign.com) for assistance.



### SMART PHONE SCAN SETUP VIDEO

